



This Datasheet applies for the following products:
200229 Battery Cell LTO 2,4V 24Ah – M12
200240 Battery Cell LTO 2,4V 24Ah – Weldable

1. Specifications

Property	Value
Weight	≤ 830g
Nominal Capacity	24Ah @ 1C (24A)
Nominal Voltage	2.4V
Nominal Energy	57.6Wh
Energy Density	69.4 Wh/kg
Resistance	≤0.5mΩ(AC, 1000Hz)
Cycle life(80% DOD)	≥ 10.000 cycles
Charging cut-off voltage	2.8V
Discharging cut-off voltage	1.5V
Standard charging current	1C(24A)
Standard discharging current	1C(24A)
Max. constant charging current	3C(72A)
Max. constant discharging current	5C(120A)
Max. charging current	6C(144A)
Max. discharging current	10C(240A)
Temperature range for storage	Less than one year: -10~25°C Less than three months: -30~45°C
Temperature range for operation	Charging temperature: -40~60°C Discharging Temperature: -50~60°C



2. Dimensions

2.1. M12 connection

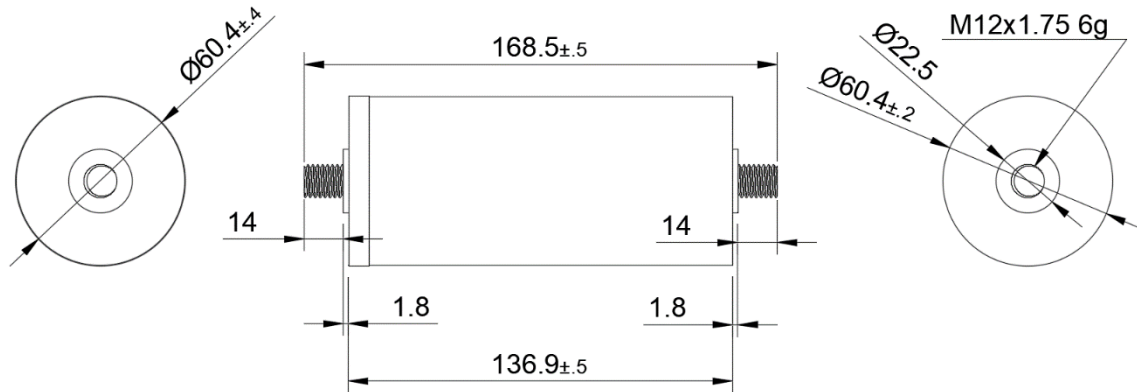

2.2. Weldable connection

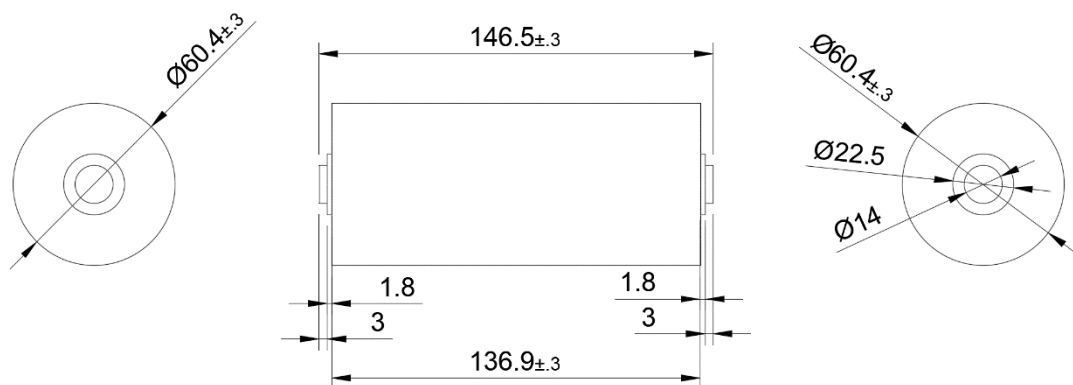

Index	00	Checked by:	AA	Released by:	JC	Page: 2 of 2
Editor:	TA	Date:	06.05.2024	Date:	07.05.2024	